

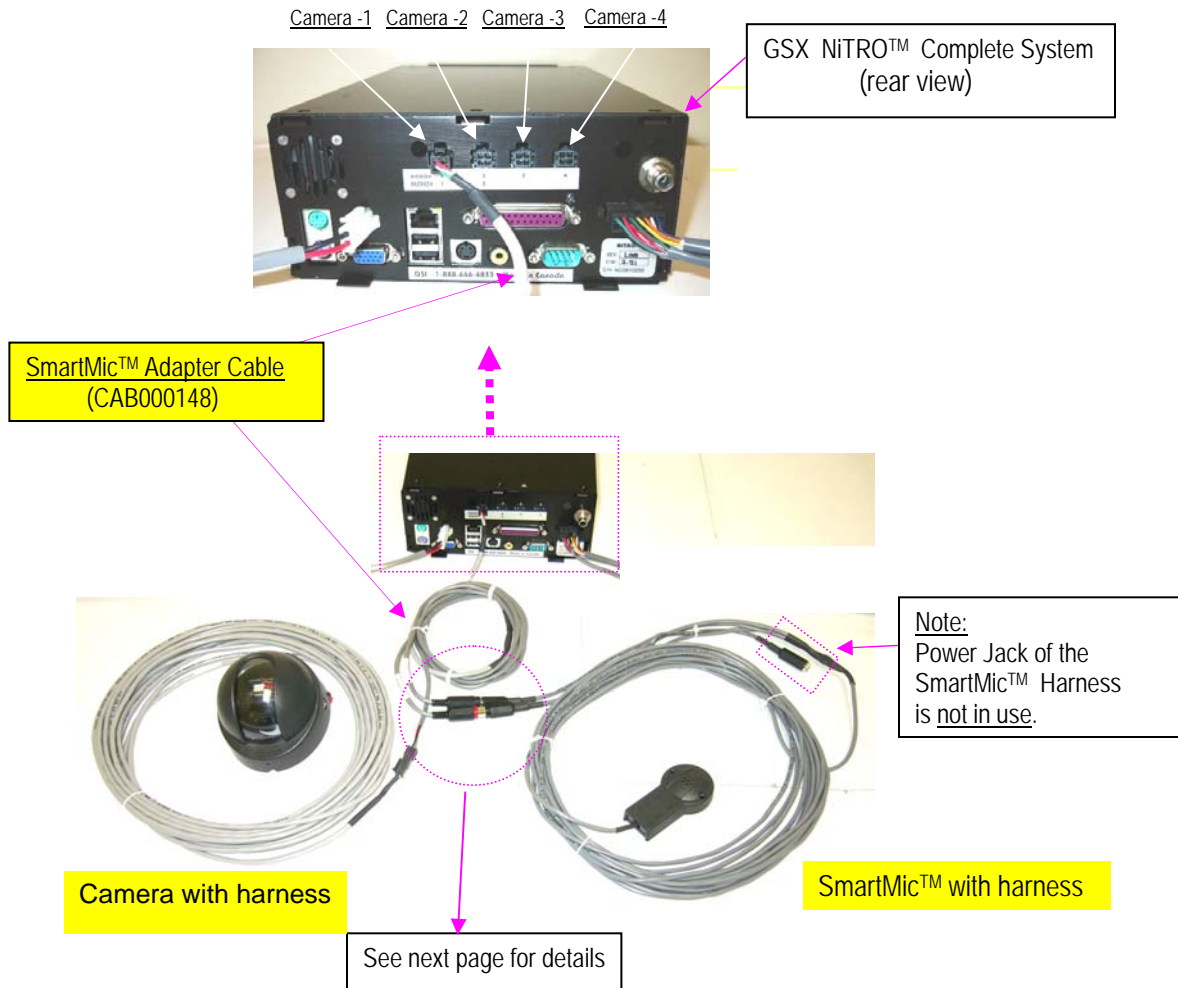

SmartMic™/Camera To NITRO™ Connection

Follow described instructions to connect the SmartMic™ (GSXMIC_XX) and Camera Harness (GSWHC2N-XX) to the NITRO™ system using SmartMic™ Adapter Cable (CAB000148).

Make sure to connect the correct input plug to the corresponding jack.





SmartMic™/Camera To NiTRO™ Connection

SmartMic™ Adapter Cable
(CAB000148)

Connect the Power Jack of SmartMic™
Adapter Cable (P/N: CAB000148) to the
Power Plug of SmartMic™ Harness.

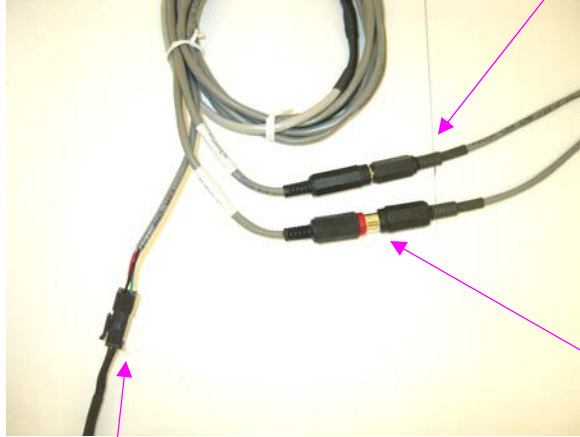

Connect the Audio plug (red) of SmartMic™
Adapter Cable (CAB000148) to the
Audio Jack of SmartMic™ Harness.

Connect the Molex Connector Receptacle
of SmartMic™ Adapter Cable (CAB000148) to
the Molex Connector Plug of Camera Harness
(GSWHC2N-XX).

Note:

Only Channel-1 and Channel-2 of the NiTRO™ system have an audio input.

Each channel with SmartMic™ requires an Adapter Cable (P/N: CAB000148) for the connection with the Camera Harness (GSWHC2N-XX) and the SmartMic™ .(GSXMIC_XX).





SmartMic™/Camera To NiTRO™ Connection

SmartMic™ installation instructions:

1. Locate an area on the bus where you would like the microphone to be mounted. It is recommended to mount the SmartMic™ in the middle of the bus, situated on the ceiling or side wall of the bus, keeping in mind the length of the SmartMic™ Harness.
2. Route the harness.
3. Complete permanent installation of the SmartMic™ by securing the SmartMic™ with provided two mounting screws.

NOTE: *If wires cannot be hidden under ceiling or wall panels, it is recommended that they be routed through plastic conduit (not supplied). Utilizing conduit will add to the overall vandal resistance of the SmartMic™ installation.*

TESTING

- Ensure proper operation of the SmartMic™ by testing the SmartMic™ while the bus is running.
- Ensure the NiTRO™ is in "RECORD" mode.
- Continue to record a few minutes while talking on the bus.
- Go to "PLAYBACK & SEARCH" and make sure the microphone is working and the sound is audible.

TROUBLESHOOTING

If no sound is heard :

- Double check that the connections are correct and in secure position.
- Ensure the SmartMic™ Assembly is connected to the SmartMic™ Harness.

If you have any questions, please contact Gatekeeper Systems Inc..

(Page -3)

Protecting Your Precious Cargo